

CSF PORSCHE 992

CARRERA / S / 4 / 4S / GTS #8217

INTERCOOLER SYSTEM

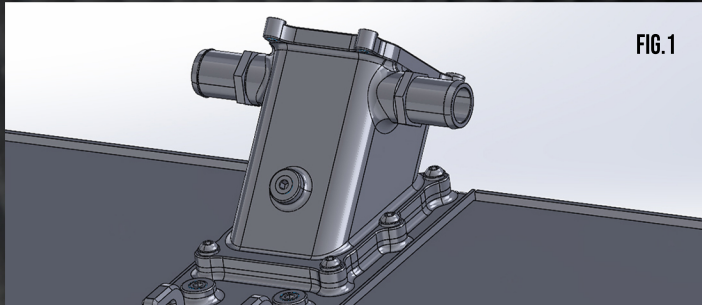

FIG. 1

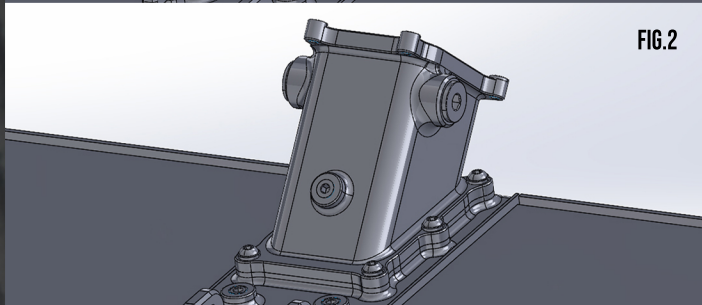

FIG. 2

STEP 1:

SELECT CHARGE PIPE NECK FITTINGS BASED ON OEM PN.

- PORSCHE PART # 992.145.805.D - USE FITTINGS IN FIGURE 1 (LEFT) FOR 922'S EQUIPPED WITH PORSCHE SOUND GENERATOR
- PORSCHE PART # 992.145.805.F - USE FITTINGS IN FIGURE 2 (RIGHT) FOR 922'S EQUIPPED WITHOUT PORSCHE SOUND GENERATOR*

*YOU CAN USE FITTINGS FROM FIGURE 2 IF YOU WISH TO DELETE/DISABLE THE OEM SOUND GENERATOR

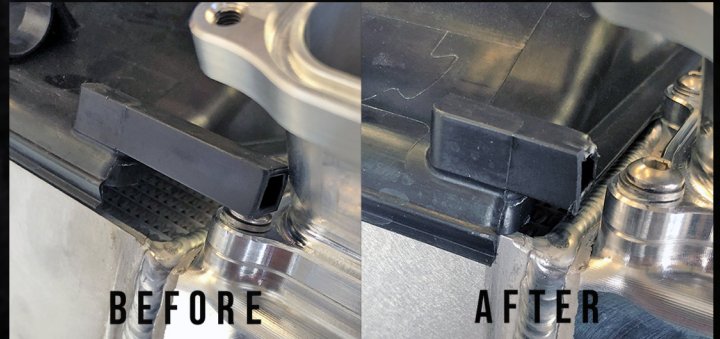

BEFORE

AFTER



STEP 2:

THE TOP LEFT AND RIGHT INTERCOOLER DUCT MOUNTING TABS MUST BE TRIMMED FOR PROPER CLEARANCE OF THROTTLE BODY Y-PIPE FLANGE CONNECTION (APPROXIMATELY .5" / 12.5MM)

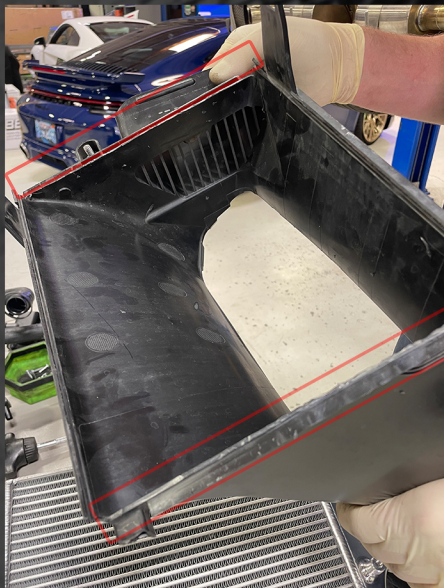

STEP 3:

TRIM THE OUTSIDES OF BOTH TOP AND BOTTOM INTERCOOLER SHROUDS (LEFT AND RIGHT) FOR ADDITIONAL CLEARANCE. THIS ALLOWS THE SHROUDS TO PROPERLY SEAT AGAINST THE INTERCOOLER CORES.

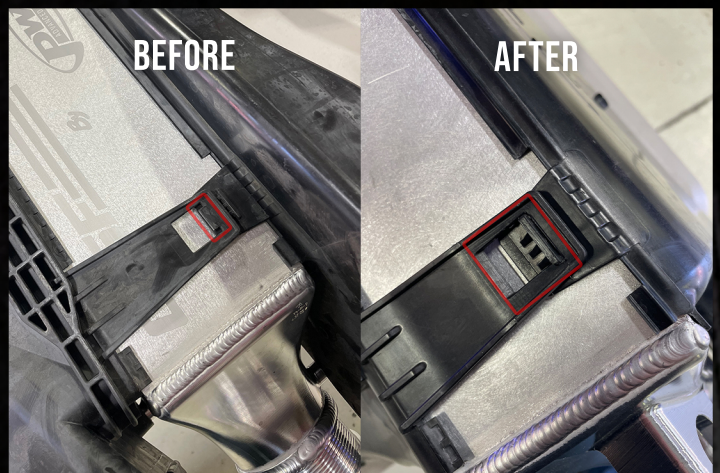

BEFORE

AFTER

STEP 4:

TRIM/REMOVE THE SMALL SQUARE TAB ON THE SHROUD STRAP. USE THE SECOND RETAINING TAB TO SECURE THE SHROUDS.