



IMPORTANT WARRANTY & INSTALLATION INSTRUCTIONS ATTACHED

*Please Forward All Attached Information to Consumer. Warranty
Not Valid Unless Returned to CORSA Exhaust*

We ask that you take a few moments to
Complete our warranty registration form.

To Activate Your 10 Year LIMITED WARRANTY, Go To:
CORSAPERFORMANCE.COM/WARRANTY



MADE IN THE USA



For Full-Color Installation Instructions, Please Visit:
CORSAPERFORMANCE.COM & Search Part #

Please be sure to review the enclosed instructions prior to beginning the installation process. If you have any questions about the enclosed parts, instructions or encounter a problem during installation, **CALL CORSA PERFORMANCE TECHNICAL ASSISTANCE AT 800.486.0999**



Exhaust System Installation
Cat-Back Exhaust System
2006-08 HUMMER H3
Dual Rear Exit with Single Pro-Series 4.0" Tips
PART NUMBER 14212

H3

Recommended Tools:

- Safety Glasses
- 15mm Socket
- Torque Wrench
- Saw or Chain Style Pipe Cutter

CAUTION: Prior to installation, be sure your vehicle is parked on a level surface, and the exhaust system is cool. For safety purposes and ease of installation, we urge you to take your vehicle to a qualified service center or muffler installer that employs the use of a lift.

Please be sure to review the attached instructions prior to beginning the installation process. If you have any questions about the enclosed parts, instructions or encounter a problem during installation, call **CORSA Performance Technical Assistance at 800.486.0999**. Do not attempt to make any modifications to parts as this will void your warranty.

Please confirm that all parts are present before beginning the factory exhaust system removal and CORSA exhaust system installation.

Bill of Materials:

- Front Pipe Assembly (23HT4011)
- Tunnel Muffler Assembly (16CB2004)
- Over Axle Pipe Assembly (23HT4014)
- Rear Muffler Assembly (23HT2009)
- (4) 2.5" Clamps
- (1) Anti-Seize Lube Pouch

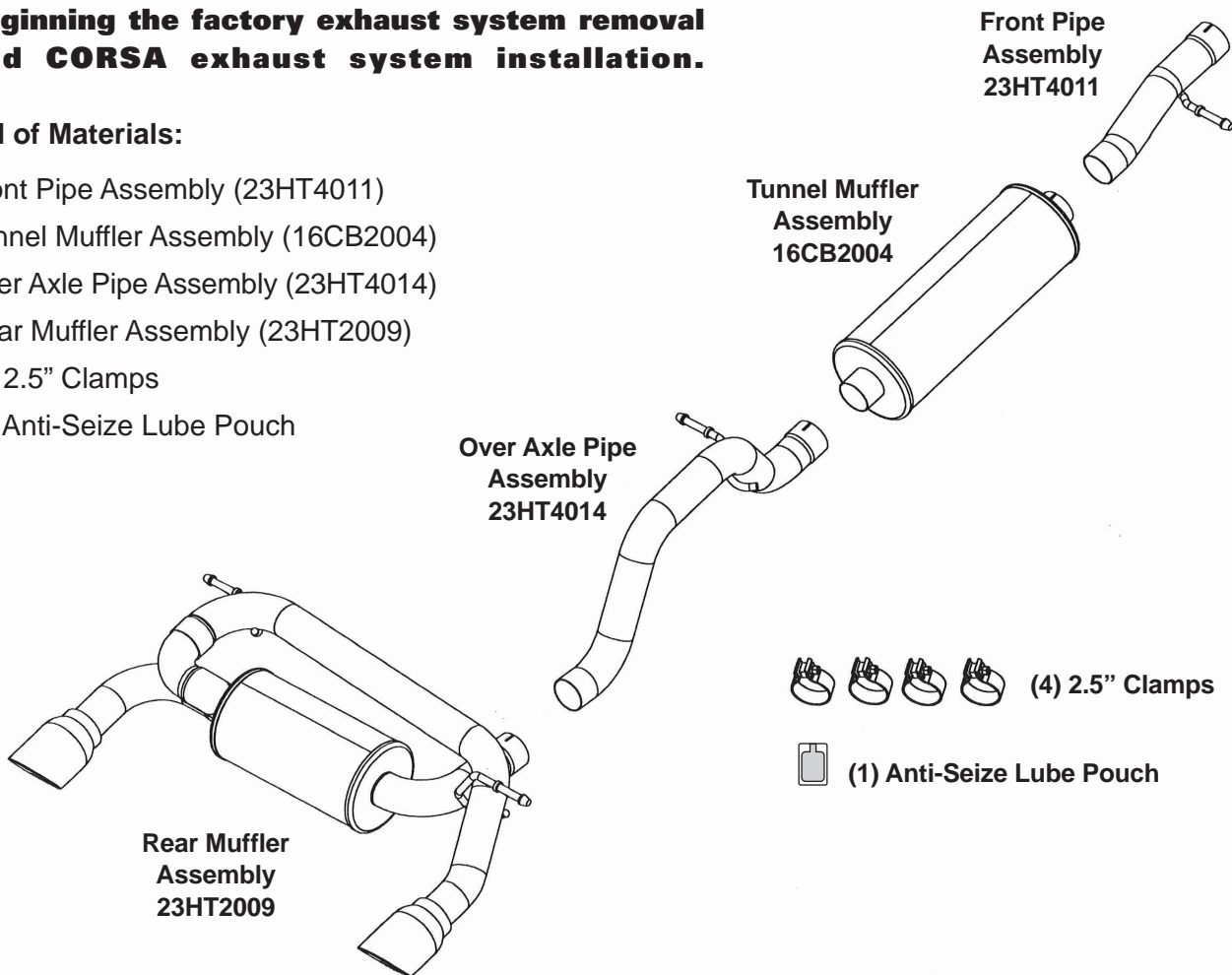

For technical assistance, call (800)486-0999.

Exhaust System Removal:

1. Using a saw or chain style pipe cutter, cut the stock system at the outlet of the tunnel muffler (See Fig. A).
2. Measure the exhaust pipe 4.5" inches rear of the exhaust flange and mark a line (See Fig. B).
3. Using a saw or chain style pipe cutter, cut the stock system at the line marked in the previous step.
4. Remove the front hanger from the rubber isolator and remove the front section of the stock exhaust system (See Fig. C).
5. Remove the hanger before the axle from the rubber isolator (See Fig. D).
6. Support the exhaust system, and remove both of the rear muffler hangers from the rubber isolators (See Fig. E).
7. Remove the remaining section of the exhaust system.

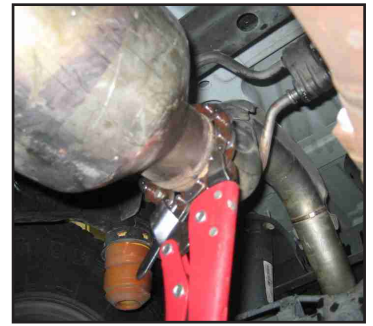

FIG. A



FIG. B



FIG. C



FIG. D

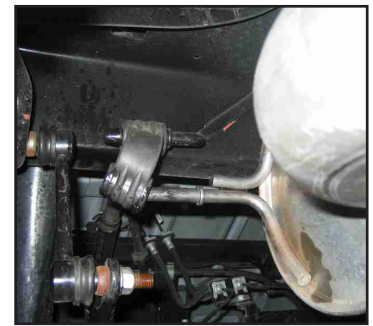

FIG. E

Exhaust System Installation:

INSTALLATION NOTE: Be sure to apply the provided anti-seize lubricant to all bolts, fasteners and clamps. A pouch is included with the hardware kit. Apply the supplied anti-seize lubricant to the threads **ONLY** of all TORCA band clamps. Failure to follow this procedure can cause the nuts to seize on clamps and potentially damage threads.

WARNING: Be sure to thoroughly clean hands after use. Anti-seize lubricant will tarnish stainless steel parts.

All clamps should be tightened using a properly calibrated Torque Wrench. Using an air impact gun will damage the clamp and reduce its ability to effectively seal the joint. It may also cause the joint to separate thereby causing damage to your exhaust system and your vehicle.

1. Remove all exhaust system components from the shipping cartons, including clamps. **NOTE: There are four 2-1/2" clamps supplied.**
2. Locate the front pipe assembly and place a TORCA clamp on the inlet (See Fig. F).
3. Slide the front pipe assembly onto the stock system, and the hanger into the rubber isolator. Snug fit clamp (See Fig. G).



FIG. F



FIG. G

4. Locate the tunnel muffler assembly and place a TORCA clamp on the inlet (See Fig. H).
5. Slide the tunnel muffler assembly onto the front pipe assembly. Snug fit clamp (See Fig. I).
6. Locate the over axle pipe assembly and place a clamp on the inlet (See Fig. J).
7. Slide the over axle pipe assembly onto the tunnel muffler assembly, and the hanger into the rubber isolator. Snug fit clamp (See Fig. K).
8. Locate the rear muffler assembly and place a clamp on the inlet (See Fig. L).
9. Slide the rear muffler assembly onto the over axle pipe assembly, and the hangers into the rubber isolators. Snug fit clamp. (See Fig. M and Fig. N).
10. Visually inspect the exhaust system position, tip alignment, clamp orientation (See Fig. O) and exhaust pipe clearances. Make any necessary adjustments at the various slip joints.
11. When the exhaust system is in the desired location, tighten all TORCA clamps working from the front to rear of vehicle. **Torque Setting: 45 ft.-lbs.**
12. It is strongly suggested that all clamps be checked and tightened after road testing the vehicle once the system has cooled.



FIG. H



FIG. I



FIG. J



FIG. K



FIG. L



FIG. M



FIG. N



FIG. O

NOTE: During cold weather start-ups, you may experience an exhaust sound that is deeper and louder in tone than usual. This is temporary and will diminish to normal levels once your engine has reached its normal operating temperature.

NOTE: Immediately following the installation of your CORSA exhaust system, you may experience a trace of smoke after initial start-up. DO NOT be alarmed. The smoke is caused by the burning of a small amount of forming oil residue used in the manufacturing process.

CORSA Performance Exhaust System Adjustment Section:

There are adjustment points at every clamp location with the CORSA Performance Exhaust system for the Hummer H3:

- Length adjustments can be made at every clamp joint.
- Rotational adjustments can be made at every clamp joint.